

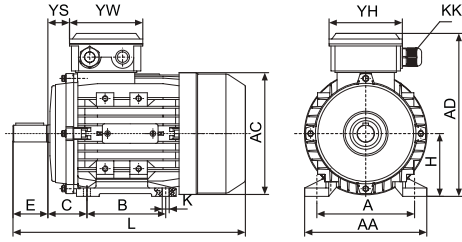

MS series Three Phase Asynchronous Motor Aluminum Housing

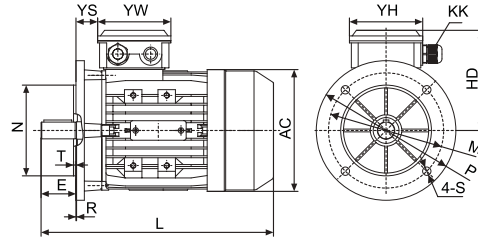

IM B3



IM B5

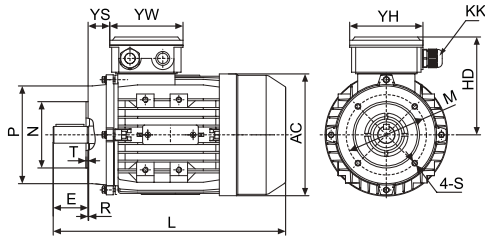

IM B14

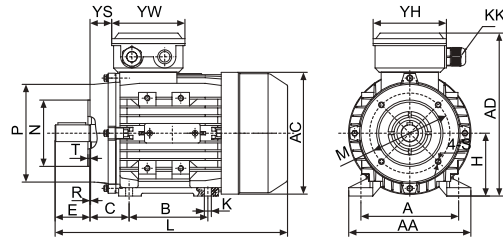

IM B34

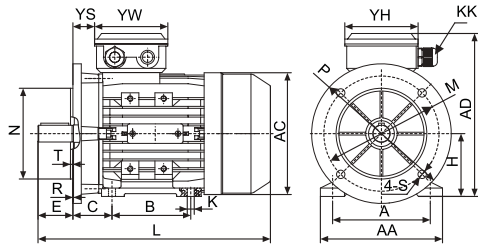

IM B35

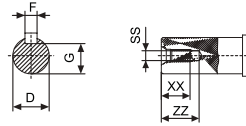

Overall & Installation Dimensions

Frame	Foot Mounting				Shaft								General							
	H	A	B	C	D	E	F	G	K	SS	XX	ZZ	AA	AD	HD	AC	L	YS	YW	YH
56	56	90	71	36	ø9	20	3	7.2	5.8x8.8	M4	9	12	110	156	100	ø117	196	14	88	88
63	63	100	80	40	ø11	23	4	8.5	7x10	M4	10	14	120	171	108	ø130	220	14	94	94
71	71	112	90	45	ø14	30	5	11	7x10	M5	12	17	132	186	115	ø147	241(255)	20	94	94
80	80	125	100	50	ø19	40	6	15.5	10x13	M6	16	21	160	213	133	ø163	290	27	105	105
90S	90	140	100	56	ø24	50	8	20	10x13	M8	19	25	175	229	139	ø183	312	30	105	105
90L1/L2	90	140	125	56	ø24	50	8	20	10x13	M8	19	25	175	229	139	ø183	337/367	30	105	105
100	100	160	140	63	ø28	60	8	24	12x15	M10	22	30	198	252	152	ø205	369/387	26	105	105
112	112	190	140	70	ø28	60	8	24	12x15	M10	22	30	220	279	167	ø229	395	32	112	112
132S	132	216	140	89	ø38	80	10	33	12x15	M12	28	37	252	318	186	ø265	437	38	112	112
132M/L	132	216	178	89	ø38	80	10	33	12x15	M12	28	37	252	318	186	ø265	475/501	38	112	112
160M/L	160	254	210/254	108	ø42	110	12	37	15x19	M16	36	45	290	384	224	ø325	640	64	143	143
180M/L	180	279	241/279	121	ø48	110	14	42.5	15x25	M16	36	45	340	440	260	ø368	730	73	190	190

Frame	B5						B14						B5R						B14B						KK	
	M	N	P	T	S	R	N	M	P	T	S	R	M	N	P	T	S	R	N	M	P	T	S	R		
56	ø100	ø80	ø120	3.0	ø7	0	ø50	ø65	ø80	2.5	M5	0	-	-	-	-	-	-	-	-	-	-	-	-	-	1-M16x1.5
63	ø115	ø95	ø140	3.0	ø10	0	ø60	ø75	ø90	2.5	M5	0	-	-	-	-	-	-	ø80	ø100	ø120	3.0	M6	0	-	1-M16x1.5
71	ø130	ø110	ø160	3.5	ø10	0	ø70	ø85	ø105	2.5	M6	0	ø115	ø95	ø140	3.5	ø10	0	ø95	ø115	ø140	3.0	M8	0	-	1-M20x1.5
80	ø165	ø130	ø200	3.5	ø12	0	ø80	ø100	ø120	3.0	M8	0	ø130	ø110	ø160	3.5	ø10	0	ø110	ø130	ø160	3.5	M8	0	-	1-M20x1.5
90	ø165	ø130	ø200	3.5	ø12	0	ø95	ø115	ø140	3.0	M8	0	ø130	ø110	ø160	3.5	ø10	0	ø110	ø130	ø160	3.5	M8	0	-	1-M20x1.5
100	ø215	ø180	ø250	4.0	ø15	0	ø110	ø130	ø160	3.5	M8	0	ø165	ø130	ø200	4.0	ø12	0	ø130	ø165	ø200	3.5	M10	0	-	2-M20x1.5
112	ø215	ø180	ø250	4.0	ø15	0	ø110	ø130	ø160	3.5	M8	0	ø165	ø130	ø200	4.0	ø12	0	ø130	ø165	ø200	3.5	M10	0	-	2-M20x1.5
132	ø265	ø230	ø300	4.0	ø15	0	ø130	ø165	ø200	4.0	M10	0	ø215	ø180	ø250	4.0	ø15	0	ø180	ø215	ø250	4.0	M12	0	-	2-M20x1.5
160	ø300	ø250	ø350	5.0	ø19	0	ø180	ø215	ø250	4.0	M12	0	-	-	-	-	-	-	-	-	-	-	-	-	-	2-M20x1.5

**This frame size has two housing sizes, the rated output is for normal "L" size, and increased output for the bigger "L" size (refer to the figures in the bracket("))



MS Series Three-Phase Asynchronous Motor Aluminum Housing

MS series aluminum housing three-phase asynchronous motors, with latest design in entirety, are made of selected quality materials and conform to the IEC standard.

MS motors have good performance, safety and reliable operation, nice appearance, and can be maintained very conveniently, while with low noise, little vibration and at the same time light weight and simple construction. These series motors can be used for general drive.



MS series Motors Technical Data IE1 Efficiency (at 50Hz)

Model	Output		Current (A)			Current (A)			Current (A)			Speed (r/min)	Eff			Power Factor	Tst/Tn (Times)	Tmax/Tn (Times)	Tmin/Tn (Times)	Ist/In (Times)	Noise dB(A)	W.T (kgs)	Moment of Inertia (kg·m ²)
	kW	HP	220V	380V	660V	230V	400V	690V	240V	415V	720V		100%	75%	50%								
MS56A2	0.09	0.12	0.63	0.37	0.21	0.61	0.35	0.20	0.58	0.34	0.19	2800	55.6	49.6	39.2	0.67	2.4	2.6	2.2	3.5	58	2.8	0.000102
MS56B2	0.12	0.16	0.68	0.39	0.23	0.65	0.37	0.22	0.62	0.36	0.21	2840	65.6	61.8	53.2	0.71	2.3	2.6	2.1	4.3	58	2.9	0.000128
MS56C2	0.18	0.24	0.92	0.53	0.31	0.88	0.51	0.29	0.85	0.49	0.28	2780	66.5	64.2	56.8	0.77	2.3	2.5	2.4	4.1	61	4	0.000142
MS63A2	0.18	0.24	0.92	0.53	0.31	0.88	0.51	0.29	0.85	0.49	0.28	2780	66.5	64.2	56.8	0.77	2.3	2.5	2.4	4.1	61	4	0.000150
MS63B2	0.25	0.33	1.19	0.69	0.40	1.14	0.65	0.38	1.09	0.63	0.36	2780	69.8	68.8	62.8	0.79	2.6	2.5	2.4	4.3	61	4.2	0.000171
MS63C2	0.37	0.50	1.72	1.00	0.57	1.65	0.95	0.55	1.58	0.91	0.53	2750	71.4	71.2	65.9	0.79	2.8	2.6	2.6	4.7	62	4.7	0.000203
MS71A2	0.37	0.50	1.70	0.99	0.57	1.63	0.94	0.54	1.56	0.90	0.52	2830	71.3	70.4	65.2	0.8	2.8	2.9	2	5.9	64	5.2	0.000314
MS71B2	0.55	0.75	2.52	1.46	0.84	2.41	1.39	0.80	2.31	1.34	0.77	2815	71.6	71	66.1	0.8	2.7	2.7	1.8	6	64	6.2	0.000384
MS71C2	0.75	1.0	3.25	1.88	1.08	3.11	1.79	1.04	2.98	1.72	0.99	2820	73.8	73.9	70.3	0.82	3	3	2	6.6	65	7.2	0.000476
MS80A2	0.55	0.75	2.38	1.38	0.79	2.28	1.31	0.76	2.18	1.26	0.73	2810	73.1	73.4	69.7	0.83	2.7	2.5	1.9	5.3	64	7.3	0.000752
MS80A2	0.75	1.0	3.15	1.83	1.05	3.02	1.73	1.01	2.89	1.67	0.96	2830	75.2	75.6	72.2	0.83	3	2.8	2	6.2	67	8.7	0.00088
MS80B2	1.1	1.5	4.40	2.55	1.47	4.21	2.42	1.40	4.04	2.33	1.35	2840	79	79.8	77.7	0.83	2.6	3.1	2.6	6.1	67	10.5	0.001072
MS80C2	1.5	2.0	5.70	3.30	1.90	5.46	3.14	1.82	5.23	3.02	1.74	2820	81.2	82.5	81.3	0.85	3.2	3	2.5	7.2	70	11.2	0.001329
MS90S2	1.5	2.0	5.73	3.32	1.91	5.48	3.15	1.83	5.25	3.04	1.75	2850	80.8	81.2	78.9	0.85	2.8	3.3	2.6	7.7	72	12	0.001579
MS90SB2	1.9	2.5	7.04	4.08	2.35	6.73	3.87	2.24	6.45	3.73	2.15	2850	82.1	82.6	80.7	0.84	4.2	3.6	2.9	7.8	72	13.3	0.001846
MS90L2	2.2	3.0	8.19	4.74	2.73	7.84	4.51	2.61	7.51	4.34	2.50	2860	82.9	83.4	81.4	0.85	3.7	3.9	3.3	8.8	72	14.5	0.002123
MS90LB2	3.0	4.0	11.10	6.43	3.70	10.60	6.11	3.54	10.20	5.89	3.39	2830	82.4	83.5	82.3	0.86	4.4	4.2	3.5	8	74	15	0.002491
MS100L2	3.0	4.0	10.9	6.32	3.64	10.4	6	3.48	10	5.78	3.33	2875	83.9	84.5	83	0.86	2.8	3.2	2	8.1	76	20	0.003475
MS100LB2	4.0	5.5	13.8	7.99	4.6	13.2	7.59	4.4	12.6	7.31	4.22	2870	85.5	86.5	85.8	0.89	3.2	3.4	2.2	8.8	77	24	0.004247
MS112M2	4.0	5.5	13.2	7.63	4.4	12.6	7.25	4.2	12.1	6.99	4.03	2870	85.6	87	86.8	0.93	2.6	2.85	1.75	8.1	77	26	0.005845
MS112MB2	5.5	7.5	18	10.4	6	17.2	9.9	5.74	16.5	9.5	5.5	2890	87.1	88	87.6	0.92	3.1	3.3	2	9.4	78	29.3	0.007429
MS132SA2	5.5	7.5	18.5	10.7	6.17	17.7	10.2	5.9	17	9.8	5.65	2900	86.6	87.4	86.5	0.9	2.25	3.1	1.5	7.9	80	38.4	0.011224
MS132SB2	7.5	10	24.6	14.2	8.19	23.5	13.5	7.84	22.5	13	7.51	2900	88	88.8	88.3	0.91	2.4	3.25	1.5	8.5	80	41.3	0.013838
MS132MA2	9.2	11	30.8	17.8	10.3	29.5	17	9.83	28.3	16.3	9.42	2930	88	88	86.4	0.89	2	2.2	1.2	7.5	81	48.2	0.016551
MS132MB2	11.0	15	36.3	21	12.1	34.7	20	11.6	33.3	19.2	11.1	2930	88.4	88.6	87.5	0.9	2	2.2	1.2	7.5	83	52.5	0.018641
MS160MA2	11.0	15	36.4	21.1	12.1	34.8	20	11.6	33.4	19.3	11.1	2920	88.8	89.4	88.6	0.89	2.6	2.95	1.85	7.1	86	76	0.041164
MS160MB2	15.0	20	49.3	28.5	16.4	47.2	27.1	15.7	45.2	26.1	15.1	2910	89.1	90	89.6	0.9	2.2	2.8	1.8	6.4	86	83	0.048985
MS160L2	18.5	25	59.3	34.4	19.8	56.8	32.6	18.9	54.4	31.5	18.1	2930	90.3	90.9	90.3	0.91	2.9	3.05	1.65	8.4	86	92.3	0.059935
MS180M2	22.0	30	71.3	41.3	23.8	68.2	39.2	22.7	65.3	37.8	21.8	2950	90	90.2	89.7	0.9	2	2.2	1.2	7.5	88	121	0.090185



MS series Three Phase Asynchronous Motor Aluminum Housing

MS2 series Motors Technical Data IE2 Efficiency (at 50Hz)

Model	Output		Current (A)			Current (A)			Current (A)			Speed (r/min)	Eff 100%	Power Factor (cos φ)	Tst/Tn (Times)	Tmax/Tn (Times)	Tmin/Tn (Times)	Ist/In (Times)	Noise dB(A)	W.T(kg)	Moment of Inertia (kg·m ²)
	kW	HP	220V	380V	660V	230V	400V	690V	240V	415V	720V										
MS2 71C2	0.75	1.0	3.23	1.86	1.08	3.07	1.77	1.02	2.96	1.71	0.99	2810	77.4	0.79	3.4	3.5	3	5.8	65	7.5	0.00048
MS2 80A2	0.75	1.0	3.15	1.82	1.05	2.99	1.73	1	2.88	1.66	0.96	2840	77.4	0.81	3.3	3.5	2.7	6.9	67	8.9	0.000852
MS2 80B2	1.1	1.5	4.43	2.56	1.48	4.21	2.43	1.4	4.06	2.34	1.35	2860	79.6	0.82	3.5	3.7	2.8	7.2	67	10.6	0.001109
MS2 80C2	1.5	2.0	5.99	3.46	2	5.69	3.29	1.9	5.49	3.17	1.83	2860	81.3	0.81	3.7	3.8	2.9	7.7	70	13	0.00143
MS2 90S2	1.5	2.0	5.85	3.38	1.95	5.56	3.21	1.85	5.36	3.09	1.79	2860	81.3	0.83	4.5	3.5	2.7	8.2	72	13.2	0.00143
MS2 90L2	2.2	3.0	8.38	4.84	2.79	7.96	4.6	2.66	7.68	4.43	2.56	2870	83.2	0.83	4.5	4.1	2.7	7.4	72	16.1	0.002181
MS2 90LB2	3.0	4.0	11.2	6.49	3.75	10.7	6.17	3.56	10.29	5.94	3.43	2880	84.6	0.83	4.5	4.1	3	9.7	74	20	0.002904
MS2 100L2	3.0	4.0	10.9	6.26	3.62	10.3	5.95	3.44	9.94	5.74	3.31	2900	84.6	0.86	3.7	3.7	2.6	9.6	76	22.7	0.003008
MS2 100LB2	4.0	5.5	13.9	8.05	4.65	13.2	7.65	4.42	12.8	7.37	4.26	2890	85.8	0.88	3.6	3.4	2.6	9.5	77	26	0.003934
MS2 112M2	4.0	5.5	14.1	8.14	4.7	13.4	7.73	4.47	12.9	7.46	4.3	2910	85.8	0.87	3.4	3.8	2.2	9.7	77	26.4	0.006266
MS2 112MB2	5.5	7.5	18.9	10.9	6.3	18	10.4	5.99	17.3	9.99	5.77	2920	87	0.88	4	4.3	3	11	78	32.1	0.007819
MS2 132SA2	5.5	7.5	18.9	10.9	6.3	18	10.4	5.99	17.3	9.99	5.77	2920	87	0.88	3.9	4	2.1	9.9	80	42.3	0.012022
MS2 132SB2	7.5	10	25.2	14.5	8.39	23.9	13.8	7.97	23	13.3	7.68	2910	88.1	0.89	3.5	3.7	1.9	9.5	80	46.2	0.014635
MS2 132MA2	9.2	11	31	17.9	10.3	29.5	17	9.82	28.4	16.4	9.47	2900	88.7	0.88	3.5	3.9	2.4	9.8	81	51.6	0.016303
MS2 132MB2	11.0	15	37.7	21.7	12.6	35.8	20.7	11.9	34.5	19.9	11.5	2930	89.4	0.86	3.5	3.9	2.4	11.5	83	54.5	0.019439
MS2 160MA2	11.0	15	36.4	21	12.1	34.6	20	11.5	33.3	19.2	11.1	2940	89.4	0.89	3.2	3.2	2.2	9	86	79.2	0.048471
MS2 160MB2	15.0	20	48.6	28	16.2	46.1	26.6	15.4	44.5	25.7	14.8	2930	90.3	0.9	3.2	3.2	2.2	9	86	96.6	0.059421
MS2 160L2	18.5	25	58.9	34	19.6	55.9	32.3	18.6	53.9	31.1	18	2930	90.9	0.91	3.2	3.2	2.2	9	86	102.5	0.068807
MS2 180M2	22.0	30	69.7	40.2	23.2	66.2	38.2	22.1	63.8	36.8	21.3	2950	91.3	0.91	2.5	2	1.4	8.1	91	128	0.095016
MS2 80B4	0.75	1.0	3.31	1.91	1.1	3.14	1.81	1.05	3.03	1.75	1.01	1410	79.6	0.75	3	2.9	2.4	5.8	58	11.1	0.00206
MS2 90S4	1.1	1.5	5.01	2.89	1.67	4.76	2.75	1.59	4.59	2.65	1.53	1420	81.4	0.71	2.8	3.1	2.6	5.6	61	13.9	0.002873
MS2 90L4	1.5	2.0	6.71	3.88	2.24	6.38	3.68	2.13	6.15	3.55	2.05	1420	82.8	0.71	3	3.1	2.7	6.2	61	16.9	0.003709
MS2 100LA4	2.2	3.0	8.92	5.15	2.97	8.47	4.89	2.82	8.17	4.72	2.72	1440	84.3	0.77	3.3	3.6	2.9	7.6	64	22.4	0.007306
MS2 100LB4	3	4.0	11.8	6.83	3.95	11.2	6.49	3.75	10.8	6.26	3.61	1440	85.5	0.78	3.4	3.6	3	7.4	64	26.4	0.009053
MS2 112M4	4	5.5	15	8.66	5	14.3	8.23	4.75	13.7	7.93	4.58	1440	86.6	0.81	2.9	3.1	2.3	8.2	65	32.3	0.013305
MS2 132S4	5.5	7.5	20.1	11.6	6.71	19.1	11	6.37	18.4	10.6	6.14	1450	87.7	0.82	2.6	3.4	2.2	8.7	71	43	0.027736
MS2 132M4	7.5	10	26.5	15.3	8.83	25.2	14.5	8.39	24.3	14	8.09	1450	88.7	0.84	3.1	3.4	2.1	8.8	71	52.6	0.035864
MS2 132MB4	9.2	11	31.9	18.4	10.6	30.3	17.5	10.1	29.2	16.9	9.75	1450	89.2	0.85	2.9	3.2	2	8.8	74	59	0.041954
MS2 160M4	11	15	38.4	22.2	12.8	36.5	21	12.2	35.1	20.3	11.7	1460	89.8	0.84	2.5	2.9	1.6	7.3	75	83	0.08963
MS2 160L4	15	20	51.9	29.9	17.3	49.3	28.4	16.4	47.5	27.4	15.8	1460	90.6	0.84	2.9	3	1.7	8.2	75	103.5	0.118354
MS2 160LB4	18.5	25	62.8	36.3	20.9	59.7	34.4	19.9	57.5	33.2	19.2	1460	91.2	0.85	2.9	3	1.7	8.1	78	114.5	0.136633
MS2 180M4	18.5	25	61.4	35.4	20.5	58.3	33.7	19.4	56.2	32.4	18.7	1460	91.2	0.87	2.4	3	1.8	7.8	80	119	0.155064
MS2 180L4	22	30	71.8	41.5	23.9	68.2	39.4	22.7	65.8	38	21.9	1460	91.6	0.88	2.4	2.8	1.7	7.7	80	129	0.173293
MS2 90S6	0.75	1.0	3.77	2.18	1.26	3.58	2.07	1.19	3.45	1.99	1.15	935	75.9	0.69	2.4	2.6	2.2	4.7	59	13	0.003365
MS2 90L6	1.1	1.5	5.37	3.1	1.79	5.1	2.95	1.7	4.92	2.84	1.64	940	78.1	0.69	2.7	2.7	2.3	5	59	16.4	0.004805
MS2 100L6	1.5	2.0	6.87	3.97	2.29	6.53	3.77	2.18	6.29	3.63	2.1	960	79.8	0.72	2.9	3	2.3	6.2	61	21.6	0.009554
MS2 112M6	2.2	3.0	9.44	5.45	3.15	8.96	5.18	2.99	8.64	4.99	2.88	950	81.8	0.75	2.5	2.6	2	5.6	64	29.5	0.016969
MS2 132S6	3	4.0	12.5	7.2	4.16	11.8	6.84	3.95	11.4	6.59	3.81	960	83.3	0.76	2.2	2.6	1.7	6.1	64	35.2	0.029932
MS2 132MA6	4	5.5	16.6	9.58	5.53	15.8	9.1	5.25	15.2	8.77	5.06	965	84.6	0.75	2.5	2.6	1.7	6.5	68	45	0.040259
MS2 132MB6	5.5	7.5	22.7	13.1	7.58	21.6	12.5	7.2	20.8	12	6.94	965	86	0.74	3	2.9	1.9	7.2	68	53.5	0.053408
MS2 132MC6	7.5	10	30.2	17.4	10.1	28.7	16.6	9.56	27.6	16	9.21	970	87.2	0.75	3.7	3.1	2.2	8.2	68	66.2	0.068087
MS2 160M6	7.5	10	30.6	17.7	10.2	29.1	16.8	9.69	28	16.2	9.34	970	87.2	0.74	2.8	2.9	1.6	7.1	68	72.6	0.089688
MS2 160L6	11	15	42.9	24.8	14.3	40.8	23.6	13.6	39.3	22.7	13.1	970	88.7	0.76	2.9	2.7	1.6	7.3	73	89.5	0.12273
MS2 180L6	15	20	53	30.6	17.7	50.4	29.1	16.8	48.5	28	16.2	975	89.7	0.83	2.2	2.7	1.2	8	79	130	0.254063